

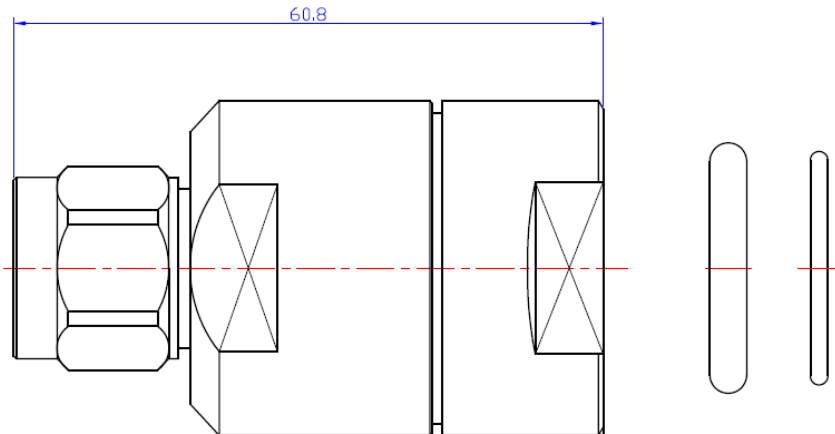

Product Specifications

NM-7/8L MT04320



1 Product Structure

	Designation	Material	Plating
1	Inner Conductor	Bronze	Silver – Plated
2	Insulator	PTFE	White
3	Body	Brass	Ternary alloy
4	Gasket	Silicone Rubber	Red
5	Nut	Brass	Nickel

2 General Specifications

Interface	N
Body Style	Straight
Cable Type	7/8L
Mating Cycle	≥ 500
Retention Force	≥0.56N
Nut Torque	3 Nm
Torsion Torque (cable-connector)	5 Nm
The minimum pull off force of the connectors	500N
Nut pull force	500N

3 Electrical Specifications

Impedance	50 Ohm	
Operating Frequency Band	DC - 3 GHz	
Insertion Loss, Typical	$\leq 0.05 \times \sqrt{F(\text{GHz})}$ dB	
VSWR	≤1.08	
IM3	≤155dBc	
Dielectric withstanding voltage	2500V	
Working voltage	1500V	
Contact Resistance	Inner Conductor	≤ 0.8mΩ
	Outer Conductor	≤ 0.2 mΩ
Insulation Resistance		≥ 5000 mΩ

4 Environment Specifications



Product Specifications

Operating Temperature	-55°C to +155°C
Storage Temperature	-55°C to +90°C
Immersion Depth	0.5 m
Immersion Test Mating	Mated
Immersion Test Method	IEC 60529:2001, IP67
Corrosion Test Method	IEC 60068-2-52 96h
Damp Heat Resistance Test Method	IEC 61169-1, Sub-clause 9.4.3
Thermal Shock Test Method	IEC 61169-1, Sub-clause 9.4.4 /US MIL-STD 202,Meth. 107,Cond.B
Vibration Test Method	IEC 61169-1, Sub-clause 9.3.3/ US MIL-STD 202,Meth. 204,Cond.B
Mechanical Shock Test Method	IEC 60068-2-27/ US MIL-STD 202,Meth. 213,Cond.I

5 Marking and Package Requirements

According to the Annex 1 and Packaging Specifications

6 Banned and Restricted Substances

RoHS 2002/95/EC Compliant by Exemption

7 Document Revision Information

Revision	Description
A0	First revision